



Alaska Alcoholic Beverage Control Board

## Form AB-01: Transfer License Application

This transfer license application form is required for all individuals or entities seeking to apply for the transfer of ownership and/or location of an existing liquor license. Applicants should review **Title 04 of Alaska Statutes** and **Chapter 305 of the Alaska Administrative Code**. All fields of this form must be completed, per AS 04.11.260, AS 04.11.280, AS 04.11.290, 3 AAC 305.045 and 3 AAC 305.060.

This form must be completed and submitted to AMCO's Anchorage office, along with all other required forms and documents before any license application will be considered complete.

### Section 1 – Transferor Information

Enter information for the **current** licensee and licensed establishment.

Licensee:	Ae Kyong Lee	License #:	3009		
License Type:	Beverage Dispensary	Statutory Reference:	04.09.200		
Doing Business As:	Holding Company				
Premises Address:	No Premises				
City:	Anchorage	State:	Alaska	ZIP:	
Local Governing Body/Bodies:	Municipality of Anchorage				

Transfer Type:

- ☒ Regular transfer
- ☐ Transfer with security interest
- ☐ Involuntary retransfer
- ☐ Controlling interest transfer
- ☒ Location transfer

OFFICE USE ONLY

Complete Date:		Transaction #:	
Board Meeting Date:		License Years:	
Issue Date:		Examiner:	



Alaska Alcoholic Beverage Control Board

**Form AB-01: Transfer License Application**

**Section 2 – Transferee Information**

Enter information for the **new** applicant and/or location seeking to be licensed.

Licensee:	GOGI, LLC				
Doing Business As:	Gogi Korean BBQ				
Premises Address:	7780 Old Seward Hwy				
City:	Anchorage	State:	Alaska	ZIP:	99518
Community Council, (If applicable):	Taku Campbell Community Council				

Mailing Address:	7780 Old Seward Hwy				
City:	Anchorage	State:	Alaska	ZIP:	99518
Email:	helenas62@yahoo.com	Phone:	907-227-8197		

Designated Licensee:	Hyon (Helen) Yun			
Contact Phone:	907-227-8197	Business Phone:	907-227-8197	
Contact Email:	helenas62@yahoo.com			

Seasonal License? ☐ Yes ☒ No ☐ If "Yes", write your six-month operating period: \_\_\_\_\_

**Section 3 – Premises Information**

Premises to be licensed is:

☒ an existing facility ☐ a new building ☐ a proposed building

The next two questions must be completed by beverage dispensary (including tourism) and package store applicants only:

What is the distance of the shortest pedestrian route from the public entrance of the building of your proposed premises to the outer boundaries of the nearest school grounds? Include the unit of measurement in your answer (Must be in feet).

Morning Star Christian School - 1560.67ft  
Taku Elementary School - 1832.53ft

What is the distance of the shortest pedestrian route from the public entrance of the building of your proposed premises to the public entrance of the nearest church building? Include the unit of measurement in your answer (Must be in feet.)

Rock Church of Anchorage - 1495.89ft



Alaska Alcoholic Beverage Control Board

## Form AB-01: Transfer License Application

### Section 4 – Sole Proprietor Ownership Information

This section must be completed by any sole proprietor who is applying for a license. Entities should skip to Section 5.  
If more space is needed, please attach a separate sheet with the required information.  
The following information must be completed for each licensee and each affiliate (spouse).

This individual is an: ☐ applicant ☐ affiliate

Name:					
Address:					
City:		State:		ZIP:	
Email:		Phone:			

This individual is an: ☐ applicant ☐ affiliate

Name:					
Address:					
City:		State:		ZIP:	
Email:		Phone:			

### Section 5 – Entity Ownership Information

This section must be completed by any entity, including a corporation, limited liability company (LLC), partnership, or limited partnership, that is applying for a license. Sole proprietors should skip to Section 6.  
If more space is needed, please attach a separate sheet with the required information.

- If the applicant is a corporation, the application shall be executed by an authorized officer of the Corporation. Information must be completed below for each **stockholder who owns 10% or more** of the stock in the corporation, and for each **president, vice-president, secretary, and managing officer**.
- If the applicant is a limited liability organization, whether manager managed or member managed, the following information must be completed for each **member with an ownership interest of 10% or more** and for each **manager regardless of ownership share**.
- If the applicant is a partnership, including a limited partnership, the following information must be completed for each **partner with an interest of 10% or more**, and for each **general partner**.
- For any entity, identify all affiliates for your organization as defined at 3 AAC 305.950.

Entity Official:	Hyon Yun				
Title(s):	Manager, Member	Phone:	907-227-8197	% Owned:	100
Address:	3298 Morgan Loop				
City:	Anchorage	State:	Alaska	ZIP:	99516
Email:	helenas62@yahoo.com	Phone:	907-227-8197		



Alaska Alcoholic Beverage Control Board

**Form AB-01: Transfer License Application**

Entity Official:					
Title(s):		Phone:		% Owned:	
Address:					
City:		State:		ZIP:	
Email:		Phone:			

Entity Official:					
Title(s):		Phone:		% Owned:	
Address:					
City:		State:		ZIP:	
Email:		Phone:			

Entity Official:					
Title(s):		Phone:		% Owned:	
Address:					
City:		State:		ZIP:	
Email:		Phone:			

This subsection must be completed by any applicant that is a corporation or LLC. Corporations and LLCs are required to be in good standing with the Alaska Division of Corporations (DOC). The registered agent is either an individual resident of the state or domestic corporation authorized to transact business in the state and whose business office is the same as the registered office.

CBPL Entity #:	10265228	AK Formed Date:	04.01.2024	Home State:	Alaska
Registered Agent:	Jana Weltzin	Agent's Phone:	907-231-3750		
Agent's Mailing Address:	901 Photo Avenue, Second Floor				
City:	Anchorage	State:	Alaska	ZIP:	99503
Email:	Jana@jdwounsel.com	Phone:	907-231-3750		

Residency of Agent:

Yes No

Does your registered agent satisfy the requirement of AS 04.11.430?

☒☐



Alaska Alcoholic Beverage Control Board

**Form AB-01: Transfer License Application**

**Section 6 – Other Licenses**

Ownership and financial interest in other alcoholic beverage businesses:

Yes No

Does any representative or owner named as a transferee in this application have any direct or indirect financial interest in any other alcoholic beverage business that does business in or is licensed in Alaska?

☒☐

If "Yes", disclose which individual(s) has the financial interest, what the type of business is, and if licensed in Alaska, which license number(s) and license type(s):

16579 Gogi Korean BBQ - REPL

**Section 7 – Authorization**

Communication with AMCO staff:

Yes No

Does any person other than a licensee named in this application have authority to discuss this license with AMCO staff?

☒☐

If "Yes", disclose the name of the individual and the reason for this authorization:

Attorney Jana Weltzin and Staff 907-231-3750 Jana@jdwcounsel.com



Alcohol and Marijuana Control Office  
550 W 7<sup>th</sup> Avenue, Suite 1600  
Anchorage, AK 99501  
[alcohol.licensing@alaska.gov](mailto:alcohol.licensing@alaska.gov)  
<https://www.commerce.alaska.gov/web/amco>  
Phone: 907.269.0350

## Alaska Alcoholic Beverage Control Board

# Form AB-01: Transfer License Application

### Section 8 – Transferor Certifications

Additional copies of this page may be attached, as needed, for the controlling interest of the current licensee to be represented.

I declare under penalty of perjury that the undersigned represents a **controlling interest** of the current licensee. I additionally certify that I, as the current licensee (either the sole proprietor or the controlling interest of the currently licensed entity) have examined this application, approve of the transfer of this license, and find the information on this application to be true, correct, and complete.



Signature of transferor

**Ae Kyong Lee**

Printed name of transferor

Subscribed and sworn to before me this 26 day of March, 2025

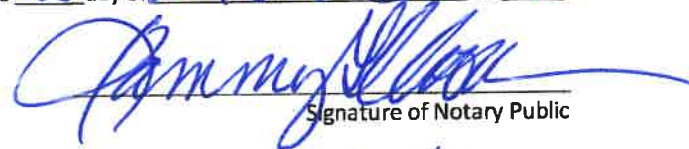

Signature of Notary Public

Notary Public in and for the State of Alaska

My commission expires: 10/1/2026

Notary Public  
TAMMY L. KROUS  
State of Alaska  
My Commission Expires October 1 2026

Signature of transferor

Printed name of transferor

Subscribed and sworn to before me this \_\_\_\_\_ day of \_\_\_\_\_, 20\_\_\_\_.

Signature of Notary Public

Notary Public in and for the State of \_\_\_\_\_

My commission expires: \_\_\_\_\_





Alaska Alcoholic Beverage Control Board

**Form AB-01: Transfer License Application**

**Section 9 – Transferee Certifications**

Read each line below, and then sign your initials in the box to the right of each statement:

Initials

I certify that all proposed licensees (as defined in AS 04.11.260) and affiliates have been listed on this application.

HY

I certify that all proposed licensees have been listed with the Division of Corporations.

HY

I certify that I understand that providing a false statement on this form or any other form provided by AMCO is grounds for rejection or denial of this application or revocation of any license issued.

HY

I certify that all licensees, agents, and employees who sell or serve alcoholic beverages or check the identification of a patron will complete an approved alcohol server education course, if required by AS 04.21.025, and, while selling or serving alcoholic beverages, will carry or have available to show a current course card or a photocopy of the card certifying completion of approved alcohol server education course, if required by 3 AAC 305.700.

HY

I agree to provide all information required by the Alcoholic Beverage Control Board in support of this application.

HY

I hereby certify that I am the person herein named and subscribing to this application and that I have read the complete application, and I know the full content thereof. I declare that all the information contained herein, and evidence or other documents submitted are true and correct. I understand that any falsification or misrepresentation of any item or response in this application, or any attachment, or documents to support this application, is sufficient grounds for denying or revoking a license/permit. I further understand that it is a Class A misdemeanor under Alaska Statute 11.56.210 to falsify an application and commit the crime of unsworn falsification.

HY

I certify that I and any individual identified in the business entity ownership section of this application, has, or will read AS 04 and its implementing regulations.

HY



Signature of transferee

Hyon Yun

Printed name

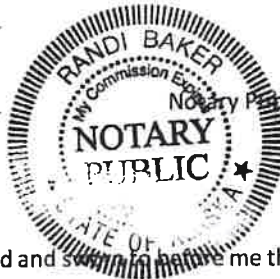



Signature of Notary Public

Notary Public in and for the State of ALASKA

My commission expires: 8.8.2026

Subscribed and sworn to before me this 25<sup>th</sup> day of ALASKA, 2025



## Alaska Alcoholic Beverage Control Board

# Form AB-02: Premises Diagram

### Why is this form needed?

A detailed diagram of the proposed licensed premises is required for all alcohol license applications, per AS 04.11.260, 3 AAC 305.630 and 3 AAC 305.660. Your diagram must include dimensions and must show all entrances and boundaries of the premises, walls, bars, fixtures, and areas of storage, service, consumption, and manufacturing.

**This form must be completed and submitted to AMCO's Anchorage office before any license application will be considered complete. You may attach blueprints or other detailed drawings that meet the requirements of this form.**

### The diagram **MUST** include:

- You must use a **solid, contiguous red line** to outline the outer perimeter of your premises with no breaks or separations.
  - The red outline is required to follow a physical barrier (wall, fence and even across doorways).
  - There should be no red lines within the perimeter
- Each area should be clearly labeled in any color other than red where alcohol is:
  - Stored
  - Served/Sold
  - Manufactured
  - Consumed
- All diagrams must include:
  - Dimensions (AMCO does not accept diagrams drawn to scale)
  - Cross streets
  - Points of reference, such as a compass rose indicating True North
  - All entrances, exits, walls, bars, and fixtures
- If your premises include multiple floors, please include a separate diagram of each floor.
  - You must identify the stairs between each floor, and each hallway/corridor that leads to each set of stairs.
- If your premises includes multiple floors, please include a separate diagram of each floor. You must identify the stairs between each floor, and each hallway/corridor that leads to each set of stairs.
- If your proposed premises is located within a building or building complex that contains multiple businesses and/or tenants, please provide an additional page that clearly shows the location of your proposed premises within the building or building complex, along with the addresses and/or suite numbers of the other businesses and/or tenants within the building or building complex.
- Any license applications that include outdoor space** are required to submit a security plan that includes information about the barriers, practices, and personnel that are to be used to ensure that alcohol is not introduced or removed from the permitted premises and to prevent the access of alcohol by a minor during the permitted event. A security plan may be requested for other proposed locations on a case-by-case basis.

## Section 1 – Establishment Information

Enter information for the business seeking to be licensed, as identified on the license application.

Licensee:	GOGI, LLC	License Number:	3009
License Type:	Beverage Dispensary		
Doing Business As:	Gogi Korean BBQ		
Premises Address:	7780 Old Seward Highway		
City:	Anchorage	State:	AK
		ZIP:	99518





Alaska Alcoholic Beverage Control Board

## Form AB-02: Premises Diagram

### Section 2 – Detailed Premises Diagram

Clearly indicate the boundaries of the premises and the proposed licensed area within that property. See above for detailed instructions.

Gogi Korean BBQ  
7780 Old Seward Highway  
License#

→ True North

- Licensed Premises
- Alcohol served/Sold and Consumed

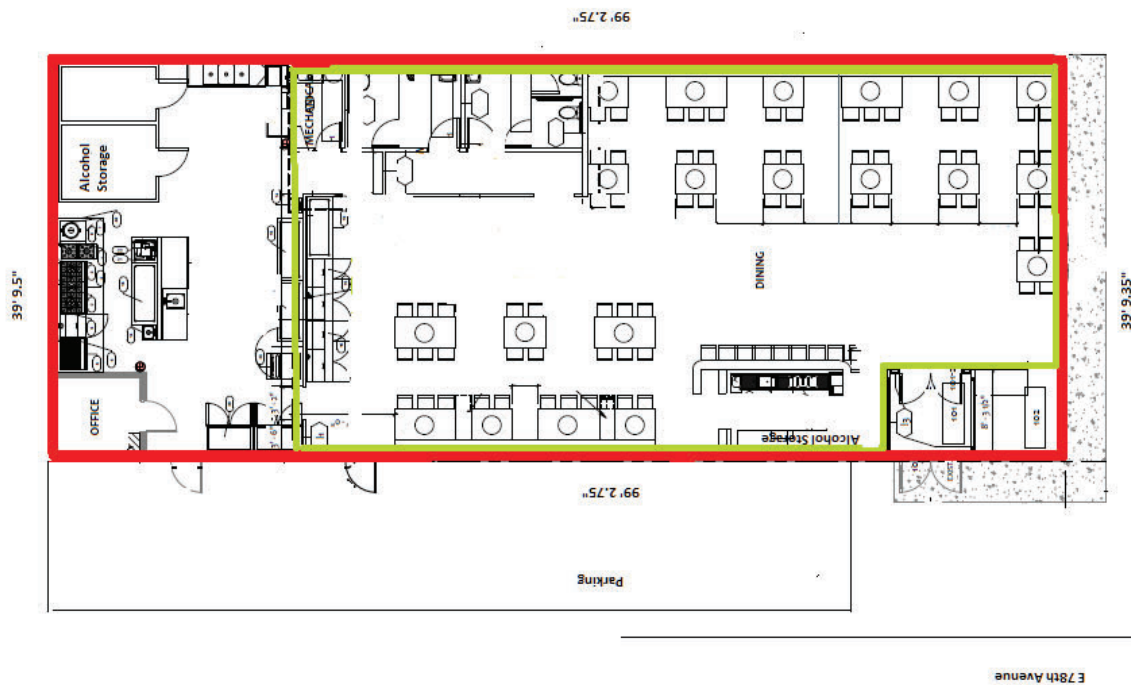

Old Seward Highway

## Alaska Alcoholic Beverage Control Board

# Restaurant Endorsement Application

This endorsement application form is required to apply for a restaurant endorsement to support your underlying license or pending license application. Applicants should review and become familiar with AS 04.09.450, **Title 04 of Alaska Statutes** and **Chapter 305** of the **Alaska Administrative Code**. This form must be completed and submitted along with all other required forms and documents before any endorsement application will be considered complete and placed in the queue for our licensing examiners review.

### Section 1 Establishment and Contact Information

Enter information for the **current** licensee and licensed establish.

Licensee:	GOGI, LLC	License #:	3009
Doing Business As:	Gogi Korean BBQ	License Type:	Beverage Dispensary
Licensee Mailing Address:	7780 Old Seward Hwy, Anchorage, AK 99518	Phone Number:	907-227-8197
Full Premises Address:	7780 Old Seward Hwy		
City:	Anchorage	State:	Alaska
		ZIP:	99518
Local Governing Body:	Municipality of Anchorage	Email:	helenas62@yahoo.com

### Section 2 Endorsement Requested

<b>Restaurant Endorsement:</b>	<b>AS 04.09.450.</b> A restaurant endorsement authorizes the holder of a beverage dispensary license, fair license, golf course license, sporting activity or event license, club license, outdoor recreation lodge license, destination resort license, or beverage dispensary tourism license. The biennial fee for a restaurant endorsement is \$200 with a \$25 application fee.
--------------------------------	---

An application for a restaurant endorsement must specify the establishment or portion of the establishment that constitutes a bona fide restaurant, that there is supervision on the premises adequate to reasonably ensure that a person under 21 years of age will not obtain alcoholic beverages. This **endorsement** application is for the request of a designation as a bona fide restaurant, hotel, or eating place for purposes of AS 04.16.010(c) or AS 04.16.049, and for the request of the following designation(s) (check all that apply):

1. ☐ Dining after standard closing hours: AS 04.16.010(c)
2. ☒ Dining by persons 16 & 20 years of age: AS 04.16.049(a)
3. ☒ Dining by persons under the age of 16 years, accompanied by a person over the age of 21: AS 04.16.049(a)
4. ☒ Employment for any persons under 21 years of age: AS 04.16.049(c)

**NOTE:** Under AS 04.16.049(d), a Department of Labor and Workforce Development work permit is not required to employ a person 18 - 20 years of age.

### Section 3 Access to Persons Under 21 Years of Age

Review AS 04.16.049(a); AS 04.16.049(c)

Be specific in your list where within the premises persons under 21 years of age are anticipated to have access in the course of either dining or employment as designated in Section 2. (Example: Persons under 21 years of age will only be allowed in the dining area OR will only be employed and present in the kitchen).

Minors will be allowed in the dining area and minors will be employed and present in the kitchen. Gogi staff will monitor their assigned areas, greet guests, monitor guests' consumption, and ensure there are no persons under 21 years of age that are not supervised by a parent or guardian. Gogi staff is also responsible to remove any abandoned drinks, empty glasses, and any unattended alcoholic beverages that customers left unconsumed to ensure minors do not gain access to unattended alcohol. Underage staff will not have access to alcoholic beverages unless they are busing a table, when they are, they will be supervised by someone over 21 years of age.

## Alaska Alcoholic Beverage Control Board

# Restaurant Endorsement Application

Describe the policies, practices and procedures that will be in place to ensure that persons under 21 years of age do not gain access to alcoholic beverages while dining or employed at your premises. Outline how and where alcoholic beverages are stored on premises. Acknowledge that employees who sell and serve alcoholic beverages must have a current Server Education Card.

Gogi will ensure that no alcohol is consumed or accessed by a minor in the establishment. All Gogi servers are TAPS certified. All minors must be accompanied by a parent or legal guardian (over the age of 21) while in the restricted area when any alcohol is being served, sold, or consumed. Underage persons will be monitored closely by our professionally trained alcohol servers. Servers will check the identification of all patrons ordering an alcoholic beverage and keep an eye on tables with minors to ensure they are not drinking alcohol. Proper signage will be posted at all points of entry indicating no minors may enter without a parent or legal guardian. All staff is trained in the identification of fake ID's. Keeping all serving areas viable without any increased risk to minors exposed to alcohol will continue to be part of our training for our staff. All servers will closely monitor that only the guests that have been carded with have alcoholic beverages.

Is an owner, manager, or assistant manager who is 21 years of age or older always present on the premises during business hours?

Yes	No
<input checked="" type="checkbox"/>	<input type="checkbox"/>

### Section 4 ☐ Food Service Establishment Permit

Per AS 04.21.080(b) for an establishment to qualify as a bona fide restaurant, a Food Service Permit or (for licenses within the Municipality of Anchorage) corresponding Department of Health and Human Services documentation is required.

**Link to the Alaska Department of Environmental Conservation (ADEC) Food Safety Website:**  
<http://dec.alaska.gov/eh/fss/food/>

**Link to the Municipality of Anchorage Food Safety Website:**  
<http://www.muni.org/Departments/health/Admin/environment/FSS/Pages/fssfood.aspx>

**IF you are unable to certify the below statement, please discuss the matter with the AMCO office:**

I have attached a copy of the current food service permit for this premises OR the plan review approval.

Initials  

**\*Note:** If a plan review approval is submitted, a final permit will be required before finalization of any permit or license application.

### Section 5 ☐ Hours of Operation

Review AS 04.16.010(c).

Include variances in weekend/weekday hours, and indicate AM/PM:

**Days/Hours of Operation**

Weekday	From Time of Day	To Time of Day
Sunday	11:00 AM	12:00 AM
Monday	11:00 AM	12:00 AM
Tuesday	11:00 AM	12:00 AM
Wednesday	11:00 AM	12:00 AM
Thursday	11:00 AM	12:00 AM
Friday	11:00 AM	12:00 AM
Saturday	11:00 AM	12:00 AM

## Alaska Alcoholic Beverage Control Board Restaurant Endorsement Application

### Section 6 ☐ Areas Covered by Endorsement

Does the endorsement apply to your entire licensed premises as approved by the ABC Board?

Yes ☒

No ☐

Does the requested endorsement expand your currently licensed premises?

Yes ☐

No ☒

- If no, attach the approved diagram, no larger than 8 1/2" x 11" of the layout, and identify the portions of the premises covered by various requested endorsements. You must use a solid, contiguous **colored** line in any color other than red to outline the outer perimeter of the area of the premises covered by the requested endorsement(s).
- If endorsements are overlapping, provide a conspicuous means to distinguish each endorsement from the other (e.g., keyed map with varying colors for each requested endorsement).
- **Your drawing MUST include:**
  - ☐ Dimensions in feet **not** square feet of all exterior walls and major interior walls (we do not accept diagrams drawn to scale)
  - ☐ Include cross-streets
  - ☐ A north arrow, and any significant geographical features. Points of reference, such as a compass showing North.
  - ☐ All entrances, exits, walls, bars, and fixtures
- **If your premises includes multiple floors, please include a separate diagram of each floor.** You must identify the stairs between each floor, and each hallway/corridor that leads to each set of stairs.
- **Any endorsement application that includes outdoor space** are required to submit a security plan that includes information about the barriers, practices, and personnel that are to be used to ensure that alcohol is not introduced or removed from the permitted premises and to prevent the access of alcohol by a minor during the permitted event. A security plan may be requested for other proposed locations on a case-by-case basis.

### Section 7 ☐ Entertainment & Service

Are any forms of entertainment offered or available within the licensed business or within the proposed licensed premises?

Yes ☐ No ☒

If yes, describe the entertainment offered or available and the hours in which the entertainment may occur.

*Entertainment* as described by AS 04.09.210, includes dancing, karaoke, live performances, or similar activities, but does not include recorded or broadcast performances without live participation.

Food and beverage service offered or anticipated is:



Table Service



Buffet Service



Counter Service



Other:

\_\_\_\_\_



**Alaska Alcoholic Beverage Control Board**  
**Restaurant Endorsement Application**

**Section 8 ☐ Attestations**

I certify that I understand that providing a false statement on this form or any other form provided by AMCO is grounds for rejection or denial of this application or revocation of any license issued.

Initials

HY

I certify that all licensees, agents, and employees who sell or serve alcoholic beverages or check the identification of a patron will complete an approved alcohol server education course, if required by AS 04.21.025, and while selling or serving alcoholic beverages, will carry or have available to show a current course card or a photocopy of the card certifying completion of approved alcohol server education course, if required by 3AAC 305.340.

HY

I agree to provide all information required by the Alcoholic Beverage Control Board in support of this application.

HY

I hereby certify that I am the person herein named and subscribing to this application and that I have read the complete application, and I know the full content thereof. I declare that all of the information contained herein, and evidence of other documents submitted are true and correct. I understand that any falsification or misrepresentation of any item or response in this application, or any attachment, or documents to support this application, is sufficient grounds for denying or revoking a license, and or endorsement. I further understand that this is a Class A misdemeanor under AS 11.56.210 to falsify an application and commit the crime of unsworn falsification.

HY

Hyon Yan

Printed name of licensee



Signature of licensee

8/8/2025

Date

# GO GI LUNCH GO GI

Mon - Fri, 12noon - 4pm only

## GO GI LUNCH COMBINATION BBQ

Comes with banchan, 2 salads

### PORK SPECIAL \$75

Pork Belly 삼겹살

Thinly Sliced Pork Belly 대패삼겹살

Marinated Pork Short Ribs 돼지갈비

### BEEF SPECIAL \$85

Bulgogi 불고기

Thinly Sliced Beef Brisket 차돌박이

Beef Belly 우삼겹살



Spicy Stir-Fried Squid



Dopbop of Spicy Pork Bulgogi



Pork Bulgogi Box



Banchan (Sided Dish)

## GO GI KOREAN GO GI

<b>Dupbop 닭밥</b> Choice of beef or pork or chicken or japchae or spicy pork bulgogi	\$19
<b>Squid Dupbop 닭밥</b>	\$22
<b>Beef Bulgogi Box 불고기 박스</b> Bulgogi, Japchae, Kimchi, Steamed Rice, 2 other side dishes	\$25
<b>Pork Bulgogi Box 돼지불고기 박스</b> Pork Bulgogi, Japchae, Kimchi, Steamed Rice, 2 other side dishes	\$25
<b>Chicken Bulgogi Box 닭불고기 박스</b> Chicken Bulgogi, Japchae, Kimchi, Steamed Rice, 2 other side dishes	\$25
<b>SoonDooBoo 순두부</b> Choice of Beef or Pork or Seafood zucchini, mushroom, egg, green onion with spicy sauce	\$25
<b>Galbitang 갈비탕</b> Galbi, radish, green onion and egg	\$35
<b>Tteokbokki 떡볶이</b> Rice cakes, fish cakes, mixed vegetables and boiled egg	\$25 Add Cheese \$3
<b>Bibim Naengmyeon 비빔냉면</b> Buckwheat noodles, radish, egg, cucumber and spicy sauce	\$28
<b>Mool Naengmyeon 물냉면</b> Buckwheat noodles, radish, egg, cucumber	\$28
<b>Japchae 잡채</b> Glass noodles, onions, carrots, mushrooms, green onions and slices of beef	\$25
<b>Kimchi Fried Rice 김치볶음밥</b> Kimchi and egg	\$20
<b>Vegetable Fried Rice 볶음밥</b> Vegetable medley, egg and rice	\$20
<b>Kimchi Stew 김치찌개</b> Kimchi, tofu and pork	\$20
<b>Soybean Stew 완장찌개</b> Zucchini, onions and green onions, potatoes	\$20

<b>Kimchi Pancake 김치전</b> Kimchi, flour	\$25
<b>Seafood Pancake 해물파전</b> Squid, shrimp, imitation crabs and green onions	\$27
<b>Hot Stone Bibimbab 돌솥비빔밥</b> Sauteed vegetables, beef and egg	\$35
<b>Spicy Stir-Fried Squid 오징어볶음</b> Squid, onion, cabbage, carrots	\$35
<b>Braised Beef Short Ribs 갈비찜</b> Glass noodles, rice cakes, mushrooms, cabbage, carrots	\$50 Add Cheese \$3
<b>Spicy Braised Beef Short Ribs 매운갈비찜</b> Spicy sauce, glass noodles, rice cakes, mushrooms, cabbage, carrots	\$50
<b>Steamed Egg 계란찜</b>	\$15
<b>Dumpling 만두</b> Beef mixed with vegetables	\$15
<b>Garlic Noodle 마늘국수</b> Egg noodles, garlic, butter sauce, green onion and parmesan cheese	\$18
<b>Lettuce 상추</b>	\$8
<b>Veggie Plate</b> Asparagus, onions, mushrooms	\$10
<b>Steamed Rice 흰밥</b>	\$3
<b>Corn Cheese 콘치즈</b>	\$15

- Consuming raw or undercooked meats, poultry, seafood, shellfish, or eggs may increase your risk of foodborne illness, especially if you have a medical condition.

- Food Allergy Notice: please be advised that food prepared here may contain these ingredients: milk, eggs, wheat, soybean, fish and shell fish.

GoGi has a policy not to reimburse or return the food and drink items ordered by the customers.

Our employees explain to you, as per request, all the ingredients and tastes of each item before we serve you. Thank you.



Wagyu Tomahawk Steak



Order ToGo or Delivery [www.GoGi907.com](http://www.GoGi907.com)

GoGiBBQ907

GoGiKoreanBBQ907

We deliver with DoorDash



Dumpling



Seafood Pancake



Tteokbokki



Bibimbab

### KOREAN DISH

Kimchi Fried Rice 김치볶음밥	Kimchi, and egg	\$20
Vegetable Fried Rice 볶음밥	Vegetable medley, egg and rice	\$20
Kimchi Stew 김치찌개	Kimchi, tofu and pork	\$20
Soybean Stew 완장찌개	Zucchini, onions and green onions, potatoes	\$20
Tteokbokki 떡볶이	Rice cakes, fish cakes, mixed vegetables and boiled egg	\$25 <sup>+</sup> Add Cheese \$3
SoonDooBoo 순두부	Choice of Beef or Pork or Seafood zucchini, mushroom, egg, green onion with spicy sauce	\$25
Japchae 잡채	Glass noodle, onion, carrot, mushroom, green onion and slices of beef	\$25
Kimchi Pancake 김치전	Kimchi, flour	\$25
Seafood Pancake 해물파전	Squid, shrimp, imitation crabs and green onions	\$27
Bibim Naengmyeon 비빔냉면	Buckwheat noodles, radish, egg, cucumber and spicy sauce	\$28
Mool Naengmyeon 물냉면	Buckwheat noodles, radish, egg, cucumber	\$28
GalbiTang 갈비탕	Glass noodles, rice cakes, mushrooms, cabbage, carrots	\$30
Hot Stone Bibimbab 돌솥비빔밥	Sauteed vegetables, beef and egg	\$35
Spicy Stir-Fried Squid 오징어볶음	Squid, onion, cabbage, carrots	\$35
Braised Beef Short Ribs 갈비찜	Glass noodles, rice cakes, mushrooms, cabbage, carrots	\$50 <sup>+</sup> Add Cheese \$3
Spicy Braised Beef Short Ribs 매운갈비찜	Spicy sauce, glass noodles, rice cakes, mushrooms, cabbage, carrots	\$50

### SIDE

Steamed Rice 흰밥	\$3
Lettuce 상추	\$8
Veggie Plate Asparagus, onions, mushrooms	\$10
Steamed Egg 계란찜	\$15
Corn Cheese 콘치즈	\$15
Dumpling 만두	Beef mixed with vegetables \$15
Garlic Noodle 마늘국수	Egg noodles, garlic, butter sauce, green onion and parmesan cheese \$18

### BEEF BBQ



### COMBINATION BBQ

Comes with corn cheese, soybean stew and steamed egg, banchan, 2 salads

<b>COMBO A (for 1-2 people)</b>	<b>\$95</b>
<ul style="list-style-type: none"> <li>• Bulgogi 불고기</li> <li>• Marinated Pork Short Ribs 양념돼지갈비</li> <li>• Thinly Sliced Beef Brisket 차돌박이</li> </ul>	
<b>COMBO B (for 1-2 people)</b>	<b>\$135</b>
<ul style="list-style-type: none"> <li>• Marinated Pork Short Ribs 돼지갈비</li> <li>• Marinated Beef 주물럭</li> <li>• Pork Belly 삼겹살</li> <li>• Bulgogi 불고기</li> </ul>	
<b>COMBO C PORK SPECIAL (for 3-4 people)</b>	<b>\$150</b>
<ul style="list-style-type: none"> <li>• Pork Jowl 항정살</li> <li>• Pork Belly 삼겹살</li> <li>• Thinly Sliced Pork Belly 대패삼겹살</li> <li>• Marinated Pork Short Ribs 돼지갈비</li> </ul>	
<b>COMBO D BEEF SPECIAL (for 3-4 people)</b>	<b>\$190</b>
<ul style="list-style-type: none"> <li>• Wagyu Beef Brisket 와규차돌박이</li> <li>• Ribeye 생등심</li> <li>• Marinated Beef 주물럭</li> <li>• Beef Belly 우삼겹살</li> </ul>	



Hot Stone Bibimbab



Braised Beef Short Ribs

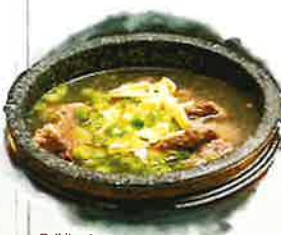

Galbitang



Kimchi Stew



BBQ order minimum 2 or more

Beef Brisket 차돌박이	\$40
Beef Brisket with Bulgogi Sauce 차돌박이 소스	\$40
LA Short Ribs, LA 갈비	\$40
Bulgogi 불고기	\$45
Spicy Bulgogi 매운불고기	\$45
Beef Belly 우삼겹살	\$45
Sirloin Gogi 고기고기	\$45
Ribeye 생등심	\$65
Marinated Beef 주물럭	\$70
Beef Kalbi Ribs 소갈비	\$75
Bonless Short Rib 꽃살	\$80
Wagyu Beef Bulgogi 와규 소불고기	\$50
Wagyu Beef Brisket 와규 차돌박이	\$65
A5 Japanese Wagyu Brisket 일본 와규 차돌	\$95
Wagyu Ribeye 와규 생등심	\$95
A5 Japanese Wagyu Steak 일본 와규 생등심	\$215

### GO GGI PORK BBQ

Pork Belly 삼겹살	\$35
Thinly Sliced Pork Belly 대패삼겹살	\$35
Marinated Pork Short Ribs 돼지갈비	\$38
Spicy Pork Bulgogi 매운돼지불고기	\$38
Pork Jowl 항정살	\$50

### GO GGI CHICKEN BBQ

Chicken BBQ 닭불고기	\$35
Spicy Chicken BBQ 매운 닭불고기	\$35

### GO GGI SEAFOOD BBQ

Shrimp 10pc 새우	\$35
Calamari 오징어	\$30
Scallop 5pc 가리비	\$35
Lobster 랍스터	\$50

### COMBO E (for 3-4 people) \$200

- Beef Kalbi Ribs 소갈비
- Marinated Pork Short Ribs 돼지갈비
- Marinated Beef 주물럭
- Pork Belly 삼겹살
- Bulgogi 불고기

### COMBO F (for 3-5 people) \$300

- Beef Kalbi Ribs 소갈비
- Marinated Pork Short Ribs 돼지갈비
- Ribeye 생등심
- Bulgogi 불고기
- Thinly Sliced Beef Brisket 차돌박이
- Pork Jowl 항정살

### GO GGI WAGYU COMBO GO GGI

Comes with corn cheese, soybean stew and steamed egg, banchan, 2 salads

### A5 JAPANESE WAGYU COMBO \$325 (for 2-3people)

- Wagyu Ribeye 와규 생등심
- Wagyu Beef Brisket 와규 차돌박이
- Wagyu Bulgogi 와규 불고기

### AMERICAN WAGYU COMBO \$215 (for 2-3people)

- Wagyu Ribeye 와규 생등심
- Wagyu Beef Brisket 와규 차돌박이
- Prime Beef Galbi 소갈비

- 18% gratuity will be added for parties of five or more people

BBQ order minimum 2 or more

Special Meat 🌶️ Spicy 🌱 Vegan

Minneapolis Area's Best  
Authentic Korean Restaurant

CONSPICUOUSLY POSTED IN A PUBLIC PLACE IN THE ESTABLISHMENT

Municipality of Anchorage  
**DEPARTMENT OF HEALTH & HUMAN SERVICES PERMIT**

PERMIT NO.  
**FA0019533**

FACILITY NAME: **GOGI KOREAN BBQ**  
OWNER'S NAME: **GOGI, LLC**  
LOCATION: **7780 OLD SEWARD HWY**

ISSUED BY THE DEPARTMENT OF HEALTH & HUMAN SERVICES AND SUBJECT TO THE ANCHORAGE MUNICIPAL CODE OF ORDINANCES  
TITLES 15 AND 16. UNLESS THE OWNERSHIP CHANGES, THIS PERMIT IS VALID FROM 1/1/2025 TO 12/31/2025

GOGI KOREAN BBQ  
7780 OLD SEWARD HWY  
ANCHORAGE, AK 99518

70-031 Ver 9\_02 \*

THIS CERTIFICATE AND PERMIT IS NOT TRANSFERABLE  
AND IS THE PROPERTY OF THE MUNICIPALITY OF ANCHORAGE